

# KELLY & THOME

## PRECISION MACHINE WORK

*Established 1960*  
POMONA, CALIFORNIA

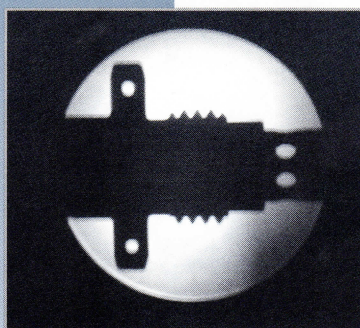
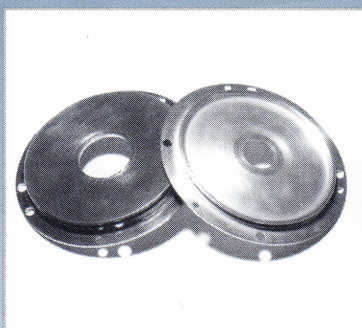
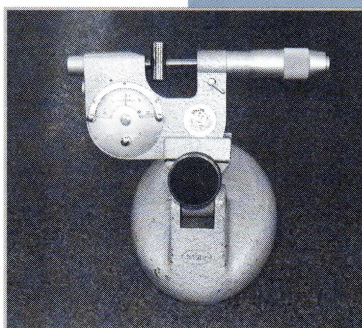
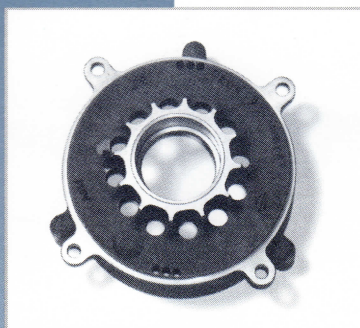
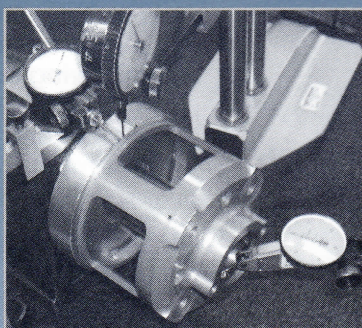

- Conventional & CNC Milling and Turning
  - Approved SPC System
  - Access to Los Angeles Processors
  - Assembly Capabilities
  - ISO 9002/AS9000 Compliant

**AS 9100C Compliant**

Tel: 909-623-2559 ■ Fax: 909-623-8239

## COMPANY BACKGROUND

**K**elly & Thome (K&T) was founded in 1960 and is located in Pomona, California, twenty-five miles east of Los Angeles. Kelly & Thome manufactures close tolerance machine parts and assemblies for the Aerospace and Electronics industries.

Capabilities exist for machining small and medium size parts from stock and castings. Conventional and CNC equipment is utilized for:

**-Turning  
-Milling  
-Drilling**

**-Grinding  
-Honing  
-Assembling**

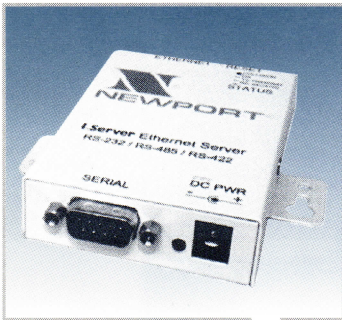

Capabilities also exist for fabricating machined parts into sub-assemblies and assemblies. Kelly & Thome's production area consists of 10,000 square feet of floor space supported by 1,500 square feet of inspection area.

Kelly & Thome's quality system is ISO 9002 and AS 9000 compliant. Kelly & Thome has an approved Statistical Process Control (SPC) system capable of monitoring both customer identified "key" characteristics and characteristics determined by Kelly & Thome as being significant in satisfying customer requirements. Kelly & Thome has strived for and achieved superior quality and "on-time" delivery performance at a competitive price for over 40 years.

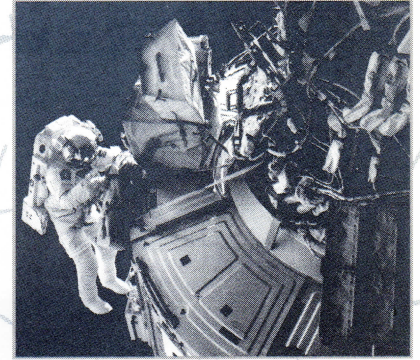

### KELLY & THOME'S QUALITY POLICY

Kelly & Thome is a **TOTAL QUALITY BUSINESS** continuously improving our processes to meet our customers' needs.

Kelly & Thome provides products of the highest quality which meet our customers' specifications and exceed their expectations.

### KELLY & THOME'S DELIVERY POLICY

Kelly & Thome is committed to "100% On-Time" delivery to meet our customers' ever increasing need for inventory reduction and scheduling changes.

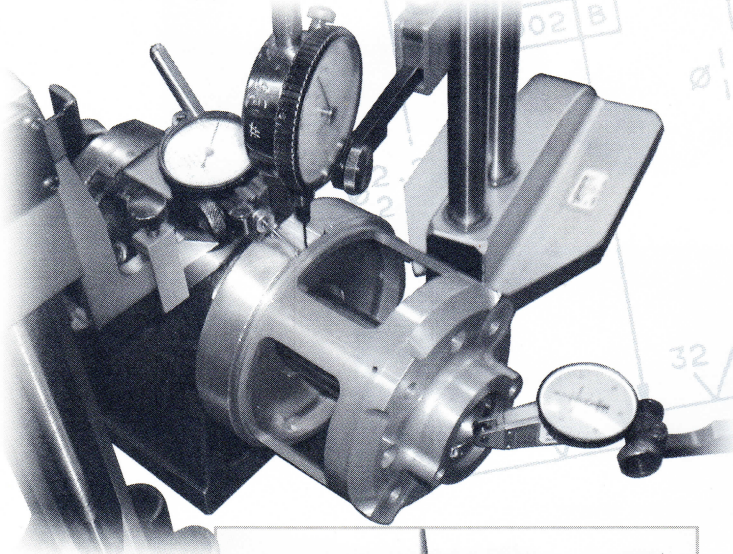

## CAPABILITIES

<b>Materials Used:</b>	Stock and castings - steel, stainless steel, aluminum, brass, bronze, titanium, and plastic.
<b>Typical lot size:</b>	1 to 500 pieces
<b>Turning:</b>	Conventional and CNC- 1/64 to 25 inch diameters
<b>Milling:</b>	Conventional and 4 axis CNC- 1/4 to 15 inch cubes
<b>Grinding:</b>	Cylindrical and Surface supporting in-house production
<b>Honing:</b>	1/4 to 3 inches
<b>Tolerances:</b>	To .0001 inches
<b>Quality System:</b>	ISO 9002/AS9000
<b>Processing:</b>	Outside-close proximity to multiple Los Angeles processors
<b>Typical Lead Times:</b>	4 weeks
<b>Assemblies:</b>	Simple to complex
<b>Welding:</b>	Outside
<b>Engineering:</b>	Available in-house
<b>Inspection:</b>	Computerized inspection reports and barcode identification

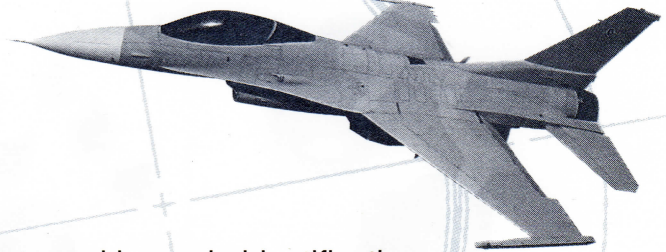

## PRODUCTS MANUFACTURED

Bosses	Guide Assemblies	Seals/Assemblies
Brackets	Housings/Assemblies	Shafts
Brake Assemblies	Impellers	Shells
Bushings	Mounts	Shrouds
Cable Assemblies	Nozzles	Sleeves
Cam shafts	Orifices	Slingers
Caps/Assemblies	Outlets	Spacers
Carriers	Pistons	Supports
Clutches/Assemblies	Plates	Threaded rods
Connectors	Plugs/Assemblies	Toruses
Covers/Assemblies	Poppets	Vanes
Elbows	Retainers/Assemblies	Washers/Assemblies
End Bells	Rings	Wheel Assemblies
Fittings	Rods/Assemblies	Wheels/Exducers
Flanges	Rotor seals	Other Parts/Assemblies

"Doing it right the first time costs less than doing it again"

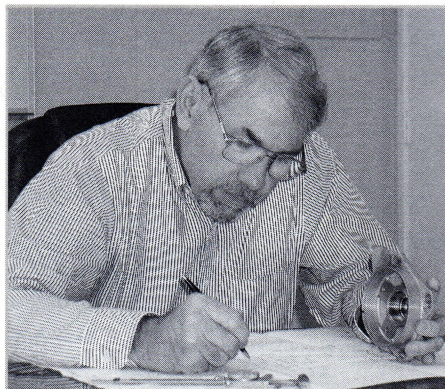
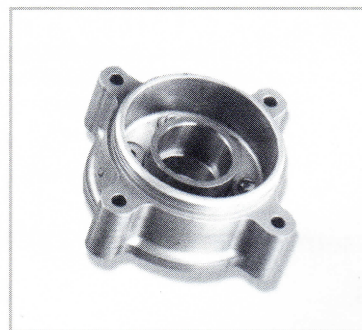
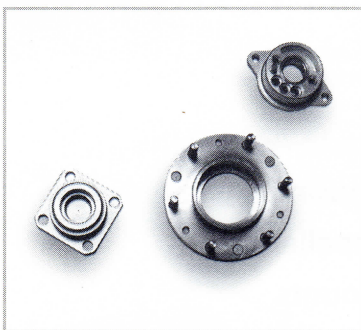
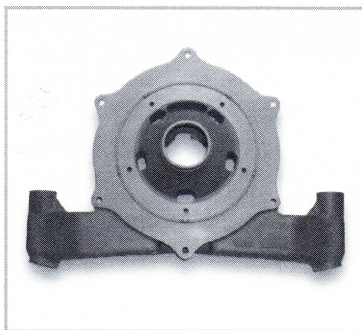
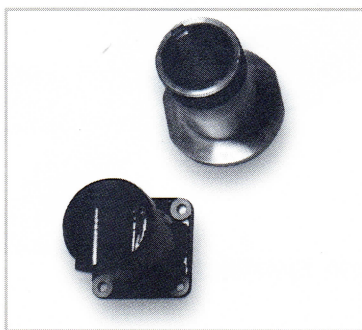

Warren Kelly  
President and Owner  
Kelly & Thome  
Engineering Degree - University of Michigan  
Business Studies - George Washington University

"Kelly & Thome is committed to Providing  
100% Quality and On-Time Delivery"

228 San Lorenzo St. • Pomona, CA 91766  
Tel: (909) 623-2559 • Fax: (909) 623-8239 • Email: WKelly@KandT.com • Website: [www.KellyandThome.com](http://www.KellyandThome.com)  
Kelly & Thome is a small business concern and a SBA Certified HUBZone company.